

# LINEAR UNIT RHL



**ROLLCO**  
SPECIALIZED  
ON LINEAR MOTION

## Index

Product overview .....	4
Technical data .....	5
RHL80 .....	6
Sliders for RHL80: V100, V250 & V500 .....	7
RHL110 .....	8
Sliders for RHL110: V200 & V500 .....	9
Mounting Plates .....	10
T-slot, Angle Bracket & Fixing Element .....	11
Sensor .....	12
Transmission & Lubrication .....	13
Order code .....	14
Product overview .....	15



# Linear Unit RHL

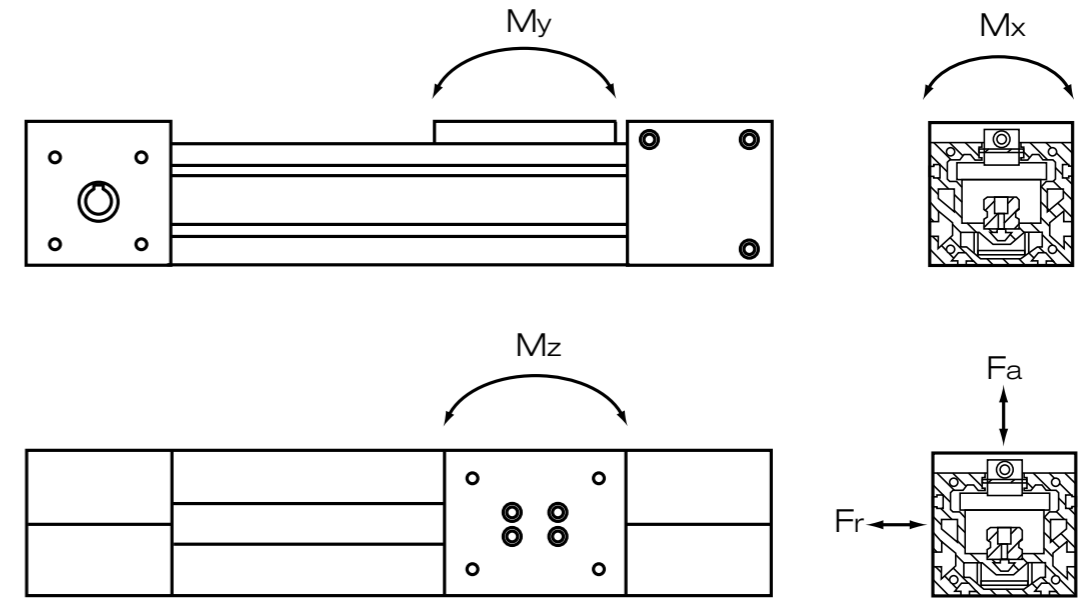

The belt driven linear units type RHL80 and RHL110 are ready to mount, complete units which saves both cost and time in the construction phase. The units are based on aluminium profile and equipped with monorail, belt and pulleys

The units are stocked in semi-finished components and can be assembled and shipped within a few days.

Customized versions can be made - please contact Rollco.

Article No.	Slider length mm	Weight/kg			Permissible load (N)		Static moment (Nm)		
		Mass of slider	Stroke 0 mm	Pr. 100 mm	Fa	Fr	Mx	My	Mz
RHL80-V100	100	0,8	5,2	0,80	1000	500	50	50	50
RHL80-V250	250	1,7	7,4	0,80	2000	1000	100	200	200
RHL80-V500	500	2,6	10,1	0,80	2000	1000	100	450	450
RHL110-V200	200	1,8	14,5	1,34	2000	1000	150	150	150
RHL110-V500	500	3,8	20,4	1,34	4000	2000	250	900	900

### RHL80

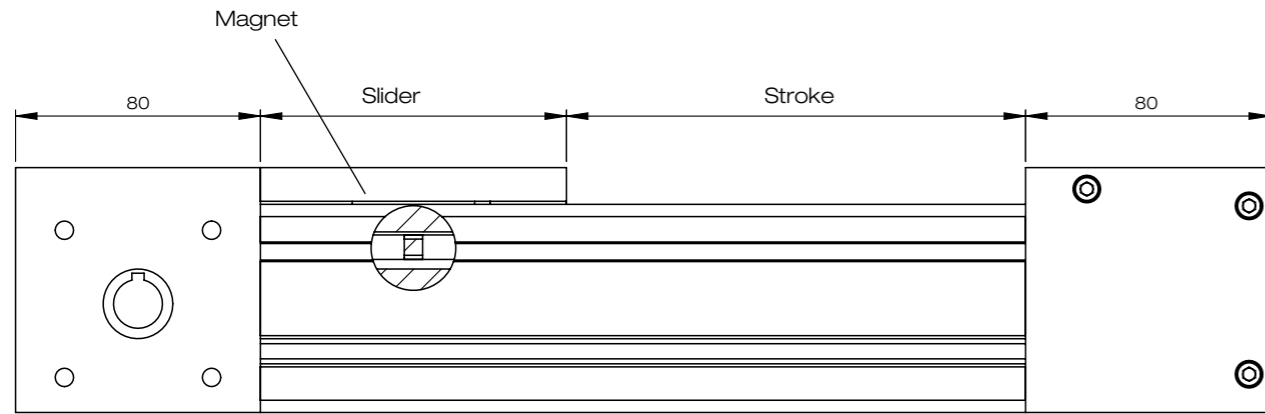

**Total length** = Stroke + slider + 160

**Stroke:** We recommend to add min. 50 mm to the nominal stroke (stroke = nominal stroke + 50 mm)

### Slider V100 for RHL80

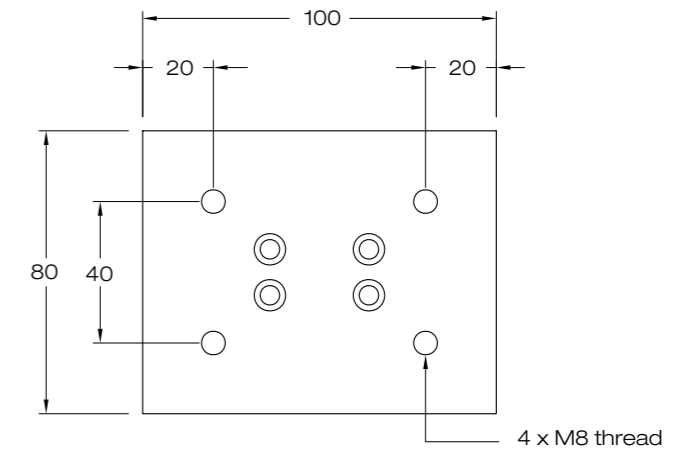

### Slider V250 for RHL80

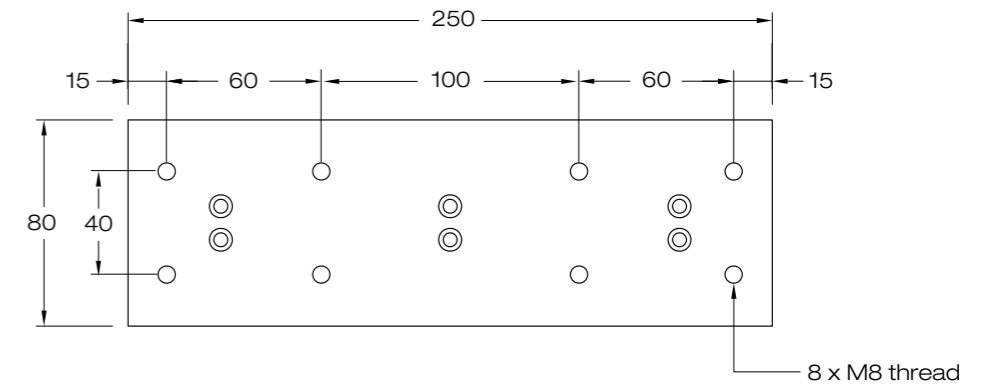

### Slider V500 for RHL80

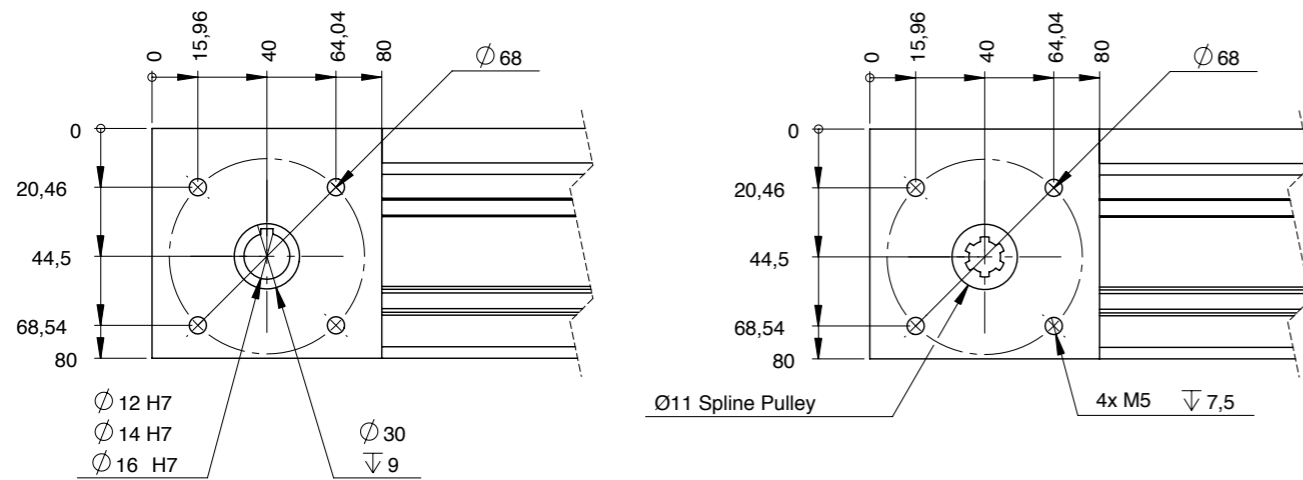
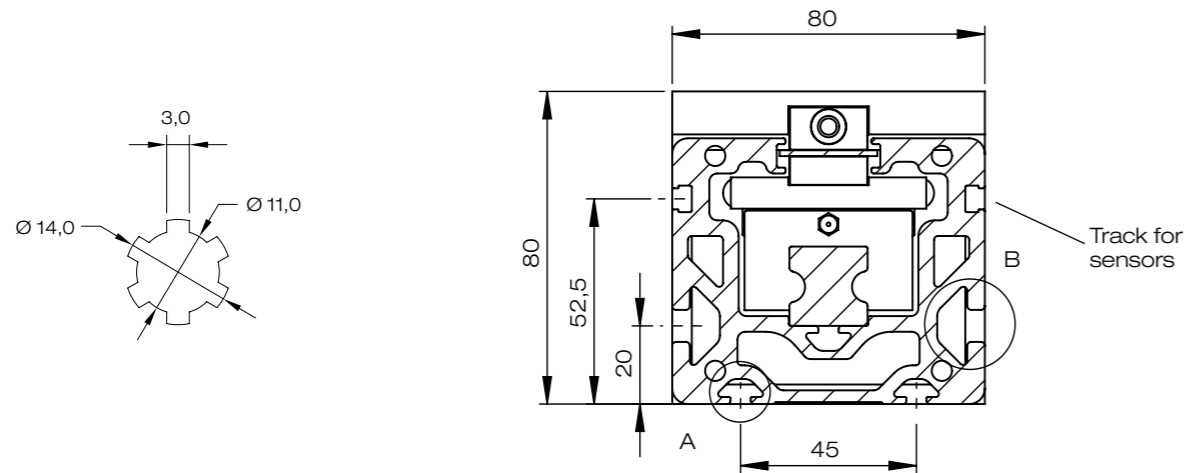
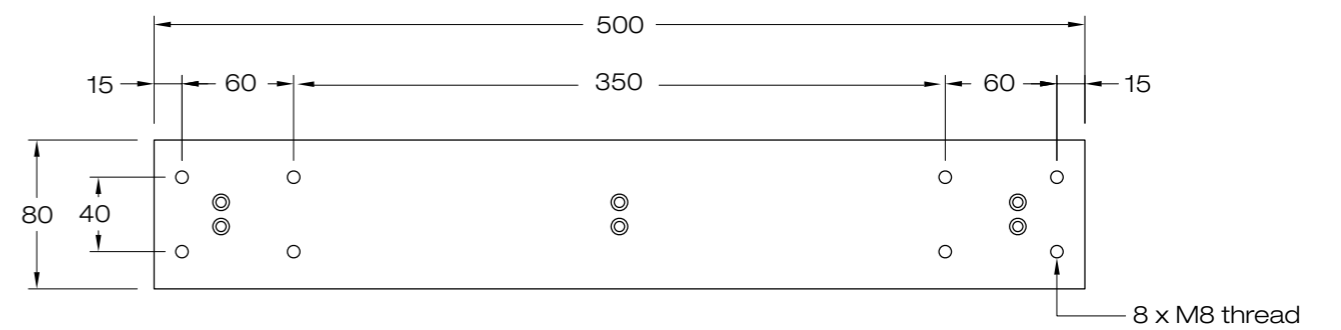

# RHL110

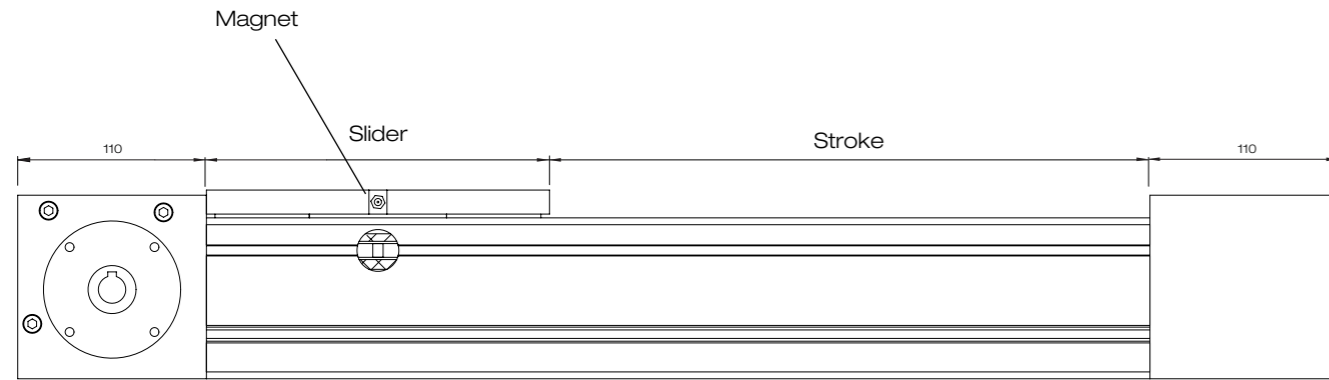

**Total length** = Stroke + slider + 220

**Stroke:** We recommend to add min. 50 mm to the nominal stroke (stroke = nominal stroke + 50 mm)

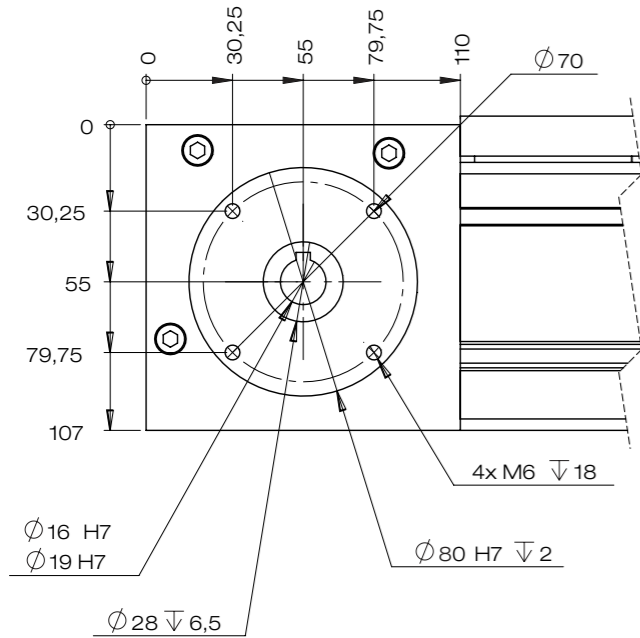
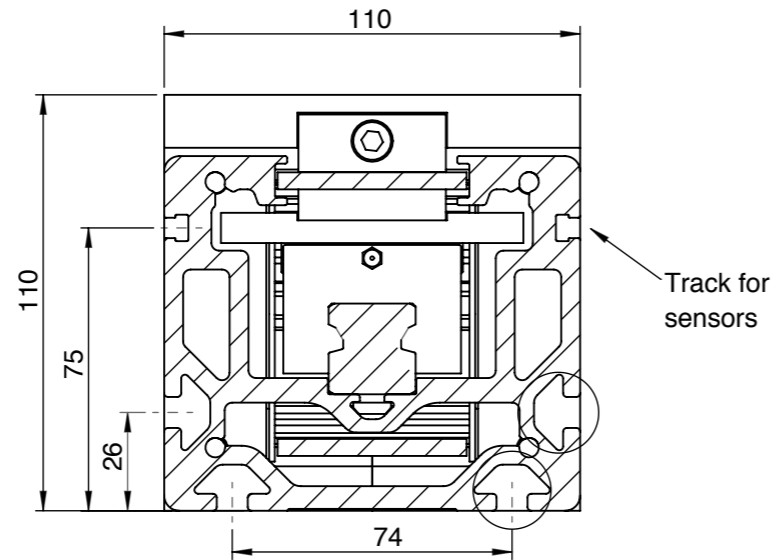

# Slider V200 for RHL110

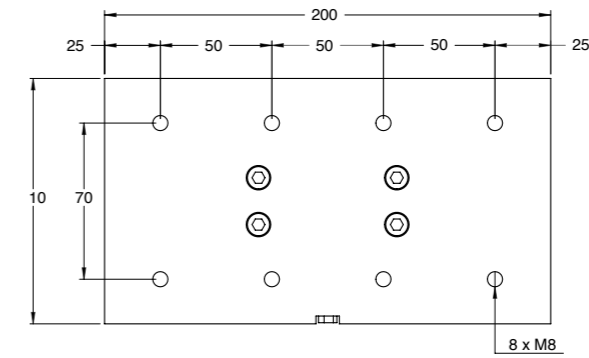

# Slider V500 for RHL110

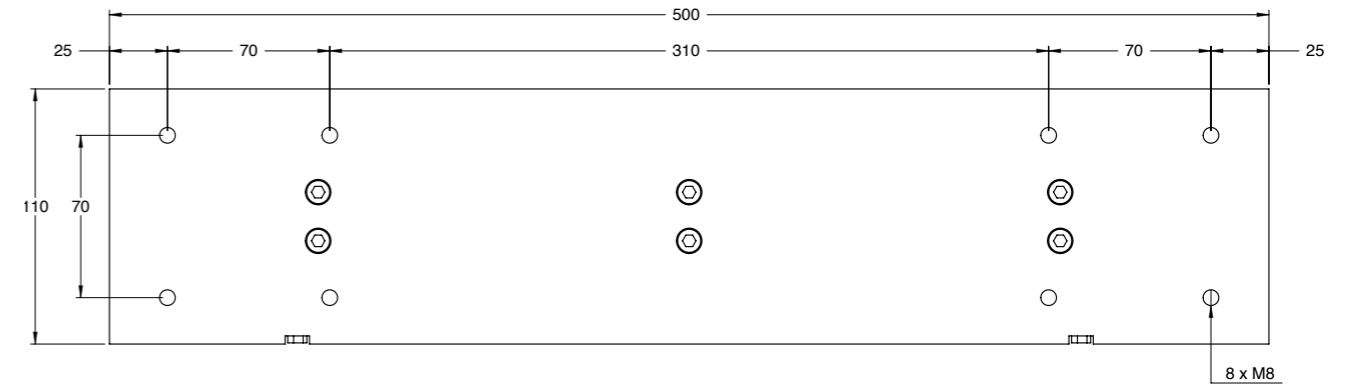

## Mounting Plate for RHL80

RHL80-MP

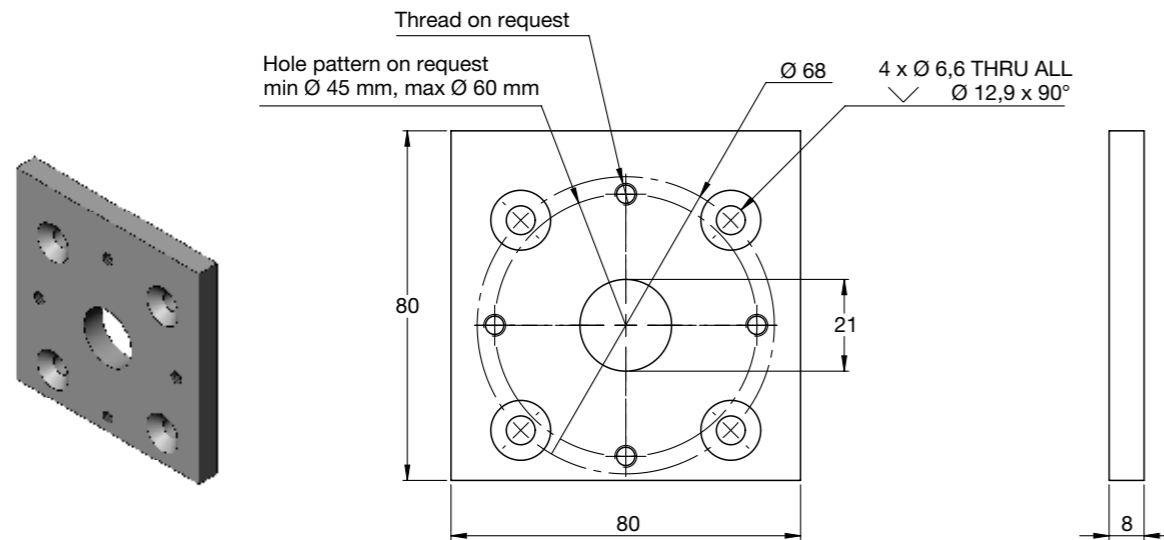

## Mounting Plate for RHL110

RHL110-MP

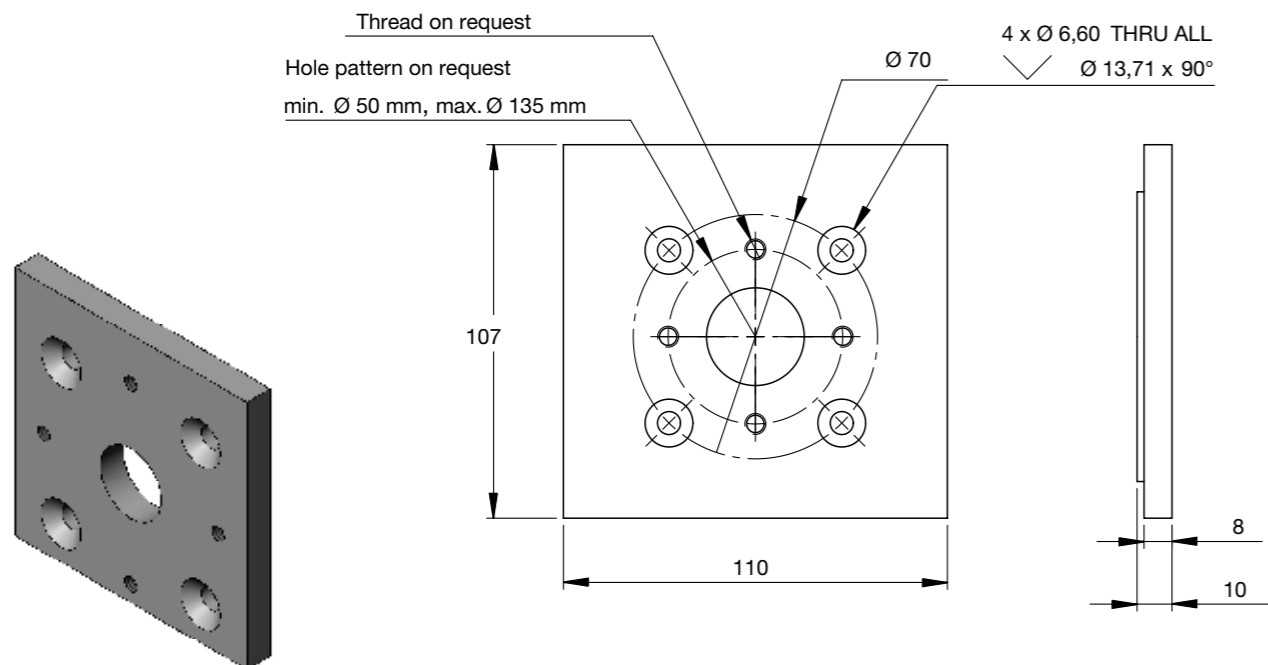

## T-slot

T-nuts available:

- PN4025 (RHL5-M3) (for RHL80)
- PN4030 (RHL5-M4) (for RHL80)
- PN4035 (RHL5-M5) (for RHL80)
- PN1035 (RHL8-M5) (for RHL80 & RHL110)
- PN1040 (RHL8-M6) (for RHL80 & RHL110)
- PN1045 (RHL8-M8) (for RHL80 & RHL110)

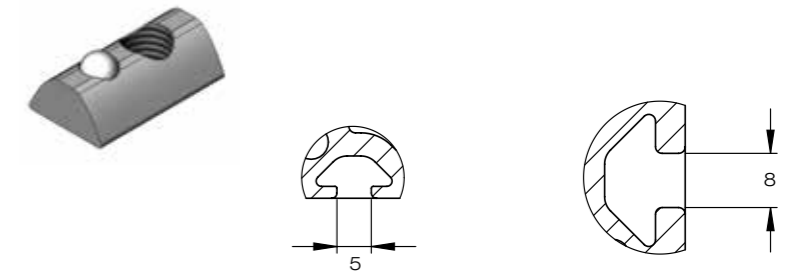

## Angle Bracket

RHL6-4040 (for RHL80 & RHL110)

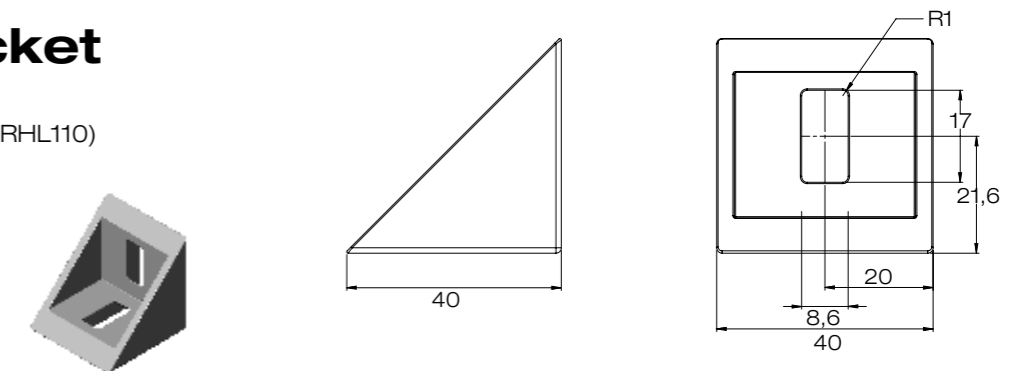

## Fixing Element

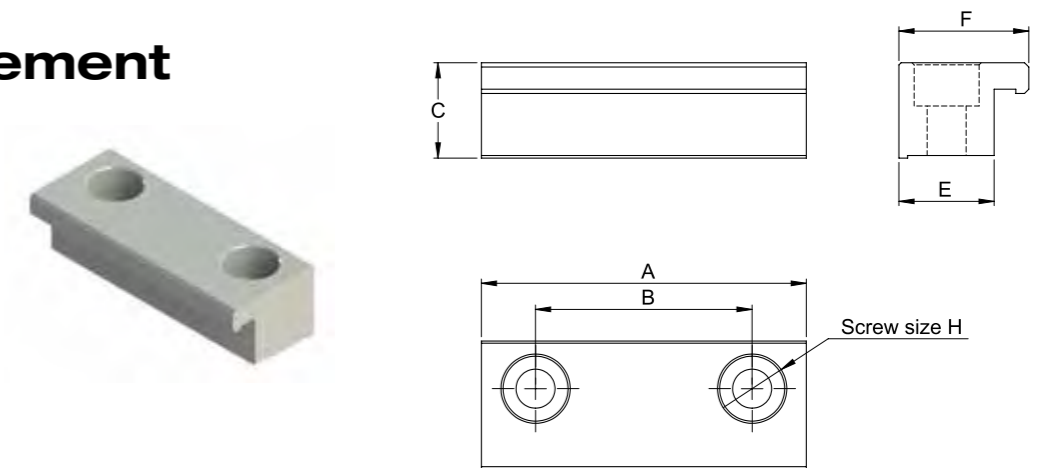

Article No.	A	B	C	E	F	H
RHL80-FE8S (side)	75	50	22	22	30	M8
RHL80-FE5B (bottom)	75	50	18,5	25	30	M8
RHL110-FE8S (side)	75	50	28	22	30	M8
RHL110-FE8B (bottom)	75	50	20	22	30	M8

## Sensor

**RHL-BMF235K-PS (Normally Open)**  
**RHL-BMF235K-PO (Normally Closed)**

- Precise readjustment
- All-electronically
- Vibration resistant
- High protection class

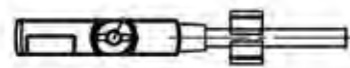
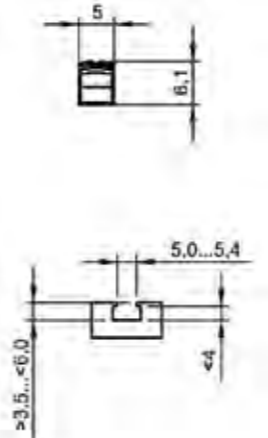
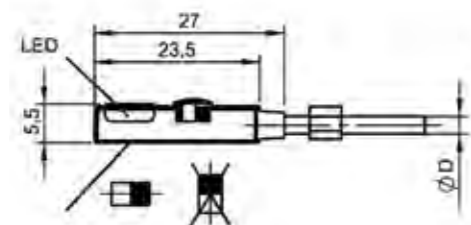

### Technical details:

	RHL-BMF235K-PS (NO)	RHL-BMF235K-PO (NC)
Service voltage	10 ... 30 V DC	
Output	PNP, NO	PNP, NC
Maximum rating	200 mA	
Contact rating	6 W max. (30 V, 200 mA)	
Internal power consumption	6 mA	
Voltage drop, static	2,5 V max	
Operating frequency	5000 Hz	
Reproducibility	<0,1 mm	
Ambient temperature	-25 ... +85 °C	
Insulation voltage endurance	75 V DC	
Protection class	IP 67	
Indicators	LED: yellow output signal	
Mounting	Hex key size 2,0 mm. Max. tightening torque 0,4 Nm	
Casing material	PA12	
Connection	Cable PUR, 2,0 m as standard	
Approval	CE	
Short circuit protected	Yes	

## Transmission

Type		RHL80	RHL110
Max. speed	(m/s)	2,5	2,5
Max. moment of rotation*	(Nm)	17	71
Pulley radius	(mm)	28,65	36,6
Belt type		AT 5	AT 10
Belt width	(mm)	25	49
Tooth pitch	(mm)	5	10
Max traction load*	(N)	600	2000
Belt breaking strength	(N)	6370	29780
Stroke for shaft revolution	(mm)	180	223

\* For higher values please contact Rollco

## Lubrication

The RHL system is equipped with sliders that are fitted with a lubrication system. This helps to keep the grease inside the block and reduce the need for relubrication. As an option the RHL system can be mounted with a so called "Maintenance Free Sealing" system, that under test has shown a life time of 32.000 KM with light load without any relubrication.

Please contact Rollco for more information.

## Order Code

	RHL80 -	1700 -	V500 -	H14
<b>Unit type</b> RHL80 RHL110				
<b>Stroke</b>				
<b>Sliders for RHL80</b> V100 V250 V500				
<b>Sliders for RHL110</b> V200 V500				
<b>Drive Hollow Shaft with Keyway or Spline Pulley for RHL80</b> Ø 12 H7 Ø 14 H7 Ø 16 H7 Ø 11 spline pulley				
<b>Drive Hollow Shaft with Keyway for RHL110</b> Ø 16 H7 Ø 19 H7				

T-slot, Angle Bracket, Mounting Plate and Sensor must be ordered separately.

## Product Overview



**BALL SCREWS**  
High efficiency ball screws and nuts.



**LINEAR UNIT QME**  
Complete linear drive unit with ball bushings and ball screws.



**LINEAR UNIT RHL**  
Complete unit with tooth belt.



**LINEAR UNITS**  
Complete unit with ball screw or tooth belt.



**ALUMINIUM PROFILES**  
A full program of aluminium profiles and accessories.



**BELT CONVEYOR**  
Transportation system with different drive options



**U-RAIL**  
Rollers in steel or polyamide. For light, standard or heavy load. Mounted in U-rails.



**COMPACT RAIL**  
No more problems with parallelism. Low noise. Lifetime lubricated bearings.

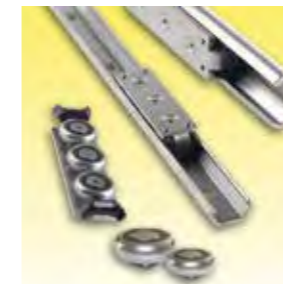

**C-RAIL**  
A simple and cost effective linear bearing system



**LINEAR RAIL SYSTEM**  
The most standardized linear rail system.



**MINIATURE**  
Range from 3 mm up to 15 mm.



**EASYSLIDE**  
A strong solution for short strokes.



**ROLLER GUIDES**  
Four raceways with rollers. High load capacity.



**HEAVY TELESCOPIC**  
The strongest solution for extraction.



**LIGHT TELESCOPIC**  
Telescopic systems for smooth movement. Steel and aluminium.



**BALL BEARINGS**  
Linear ball bearings and hardened steel shafts.

Every care has been taken to ensure the accuracy of the information contained in this catalogue but no liability can be accepted for any errors or omissions. Even partial reproduction is allowed only by written permission by Rolco.



**Rollco AB**  
Box 22234  
Ekvändan 3  
250 24 Helsingborg  
Sweden  
Tel. +46 42 150040  
Fax +46 42 150045  
[www.rollco.se](http://www.rollco.se)

**Rollco A/S**  
Ladegårdsvej 2  
7100 Vejle  
Denmark  
Tel. +45 7552 2666  
Fax +45 7552 0708  
[www.rollco.dk](http://www.rollco.dk)

**Rollco Oy**  
Sarankulmankatu 12  
33900 Tampere  
Finland  
Tel. +358 207 57 97 90  
Fax +358 207 57 97 99  
[www.rollco.fi](http://www.rollco.fi)

**Rollco Norge AS**  
Bergliveien 2  
3427 Gullaug  
Norway  
Tel. +47 32 84 00 34  
Fax +47 32 84 00 91  
[www.rollco.no](http://www.rollco.no)

**Rollco Taiwan**  
No. 28, Lane 125, Da-an Road  
Shulin District 238  
New Taipei City, Taiwan  
Tel. +886-2-8687-2726  
Fax +886-2-8687-2720  
[www.rollco-tw.com](http://www.rollco-tw.com)



**ROLLCO**  
SPECIALIZED  
ON LINEAR MOTION